

Installation Instructions

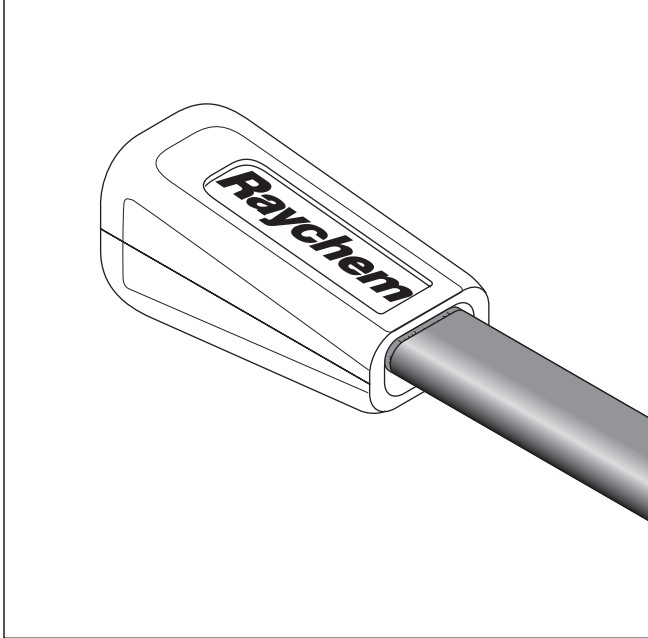

Description

This end seal is for use with Raychem IceStop, XL-Trace, HWAT and RaySol heating cables. Materials for one end seal termination are included in this kit. The appropriate Raychem power connection kit must also be used. These installation instructions should be used in conjunction with the IceStop (H56070), XL-Trace (H55617), HWAT (H53192) and RaySol (H54993) Installation and Operation Manuals.

For technical support contact your Tyco Thermal Controls representative or call Tyco Thermal Controls (800) 545-6258.

Note: The RayClic-E end seal can be installed only once; it cannot be removed from the heating cable. Do not use until ready for final installation.

Tools Required

- Utility knife
- Diagonal cutters

Approvals



718K Pipe Heating Cable
877Z De-icing and Snow-melting
Not UL Listed with XL-Trace heating cable for buried piping



DESIG. 3A, 3B, 3C – XL-Trace, IceStop
DESIG. 3A – HWAT
DESIG. 2E – IceStop



with HWAT, IceStop, and XL-Trace heating cables
Class 1, Div. 2, Groups A, B, C, D hazardous locations with GM-XT only

Kit Contents

Qty	Description
1	Gel-filled end seal

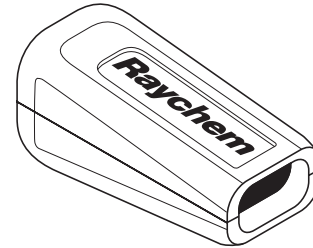

⚠ WARNING:

This component is an electrical device that must be installed correctly to ensure proper operation and to prevent shock or fire. Read these important warnings and carefully follow all the installation instructions.

- To minimize the danger of fire from sustained electrical arcing if the heating cable is damaged or improperly installed, and to comply with the requirements of Tyco Thermal Controls, agency certifications, and national

electrical codes, ground-fault equipment protection must be used. Arcing may not be stopped by conventional circuit breakers.

- Bus wires will short if they contact each other. Keep bus wires separated.
- The black heating cable core is conductive and can short. It must be properly insulated and kept dry.

- Component approvals and performance are based on the use of Tyco Thermal Controls-specified parts only. Do not use substitute parts or vinyl electrical tape.
- Use only fire-resistant insulation materials such as fiberglass wrap.
- Leave these instructions with end user for reference and future use.

RayClic-E Installation Instructions

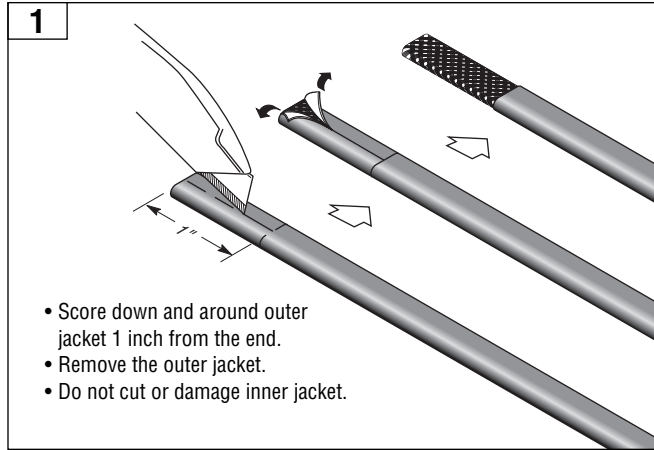
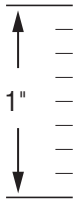

- Score down and around outer jacket 1 inch from the end.
- Remove the outer jacket.
- Do not cut or damage inner jacket.

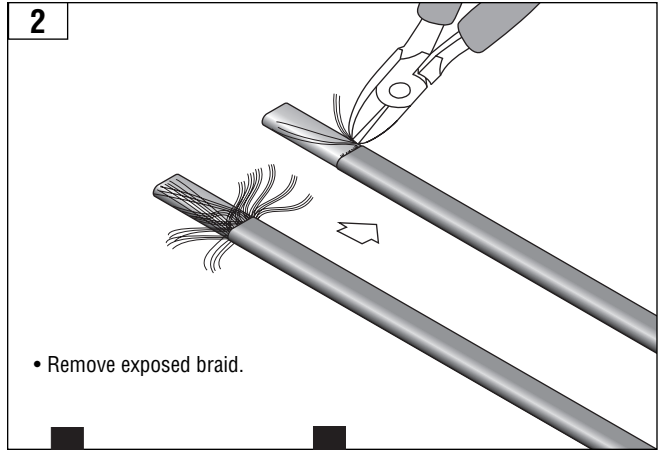

- Remove exposed braid.

HWAT

IceStop, XL-Trace, and Raysol

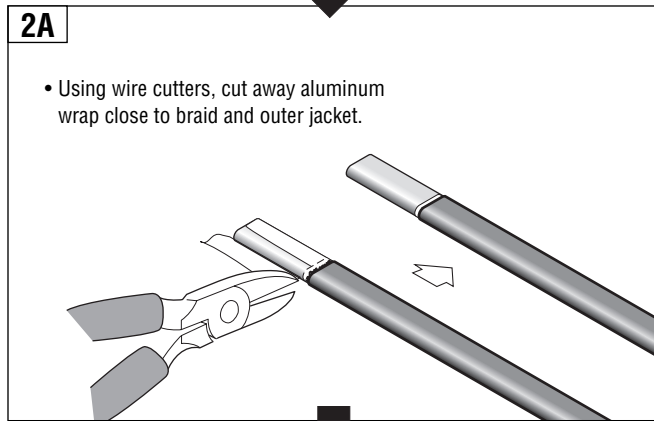

- Using wire cutters, cut away aluminum wrap close to braid and outer jacket.

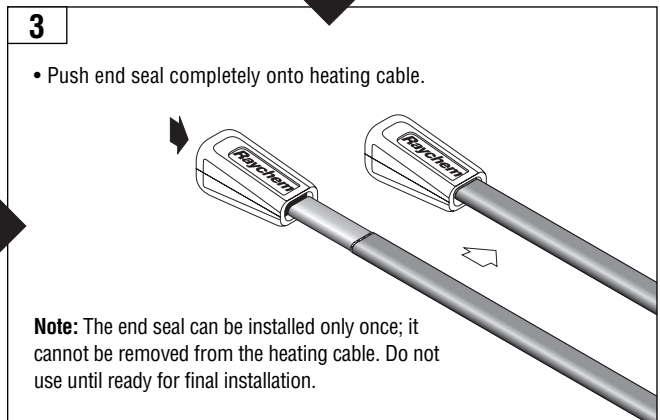

- Push end seal completely onto heating cable.

Note: The end seal can be installed only once; it cannot be removed from the heating cable. Do not use until ready for final installation.

Tyco, HWAT, IceStop, Raychem, RayClic, and XL-Trace are trademarks of Tyco Thermal Controls LLC or its affiliates.

Worldwide Headquarters
Tyco Thermal Controls
 300 Constitution Drive
 Menlo Park, CA 94025-1164
 USA
 Tel (800) 545-6258
 Fax (800) 596-5004
 info@tycothermal.com
 www.tycothermal.com

Important: All information, including illustrations, is believed to be reliable. Users, however, should independently evaluate the suitability of each product for their particular application. Tyco Thermal Controls makes no warranties as to the accuracy or completeness of the information, and disclaims any liability regarding its use. Tyco Thermal Controls' only obligations are those in the Tyco Thermal Controls Standard Terms and Conditions of Sale for this product, and in no case will Tyco Thermal Controls or its distributors be liable for any incidental, indirect, or consequential damages arising from the sale, resale, use, or misuse of the product. Specifications are subject to change without notice. In addition, Tyco Thermal Controls reserves the right to make changes—without notification to Buyer—to processing or materials that do not affect compliance with any applicable specification.