

Installation Instructions

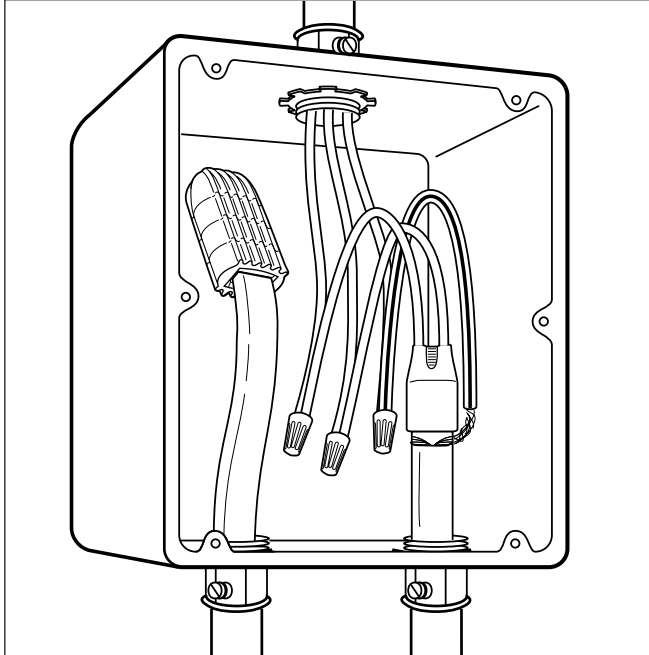

Description

The FTC-XC Power Connection and End Seal Kit is for use with XL-Trace -CR, and -CT and RaySol heating cables installed in conduit. Materials for one power connection and one end seal are included in this kit. These installation instructions should be used in conjunction with either the XL-Trace or RaySol System Installation and Operation Manual. For technical support call (800) 542-8936.

Tools Required

- Screw driver
- Utility knife
- Diagonal cutters
- Needle-nose pliers
- Heat gun or propane torch

Additional Materials Required (not provided in this kit)

- UL Listed or CSA Certified junction box suitable for the location, with a clearance hole or threaded hub for ½-inch NPT. For RaySol applications, the power connection and end seal may be terminated in the same box.

Approvals



718K Pipe Heating Cable or
9J86 Radiant Heating Cable



DESIG. 3A, 3B, 3C, 1B

Kit Contents

Item	Qty	Description
A	1	Gel-filled end seal
B	2	Black heat-shrinkable tubes (½" x 5½")
C	1	Green/yellow heat-shrinkable tube (¼" x 5½")
D	1	Black heat-shrinkable tube (½" x 1½")
E	3	Wire nuts
F	1	RaySol circuit tag
G	2	Warning labels

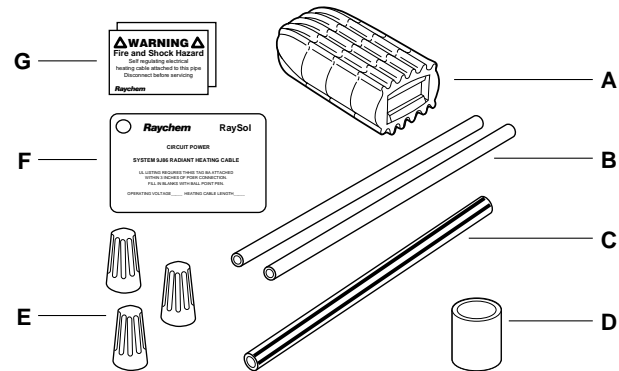

⚠ WARNING: The contents of this kit must be installed correctly to ensure proper operation and to prevent shock or fire. Read these important warnings and carefully follow all the installation instructions.

- To minimize the danger of fire from sustained electrical arcing if the heating cable is damaged or improperly installed, use a ground-fault protection device. Arcing may not be stopped by conventional circuit breakers.
- Component approvals and performance are based on the use of specified parts only. Do not substitute parts or use vinyl electrical tape.

- The black heating cable core is conductive and can short. It must be properly insulated and kept dry.
- Damaged bus wires can overheat or short. Do not break bus wire strands when preparing the cable for installation.
- Bus wires will short if they contact each other. Keep bus wires separated.
- Heat-damaged components can short. Use a heat gun or a torch with a soft, yellow, low-heat flame, not a blue focused flame. Keep the flame moving to avoid overheating, blistering, or charring the heat-shrinkable tubes. Avoid heating other components. Replace any damaged parts.

- Use only fire-resistant insulation materials such as fiberglass wrap.
- Do not remove or rotate the end seal once the cable has been inserted.
- Leave these installation instructions with the user for future reference.

⚠ WARNING: Overheating heat-shrinkable tubes will produce fumes that may cause irritation. Use adequate ventilation and avoid charring or burning. Consult MSDS RAY/3122 for further information.

Installation Instructions

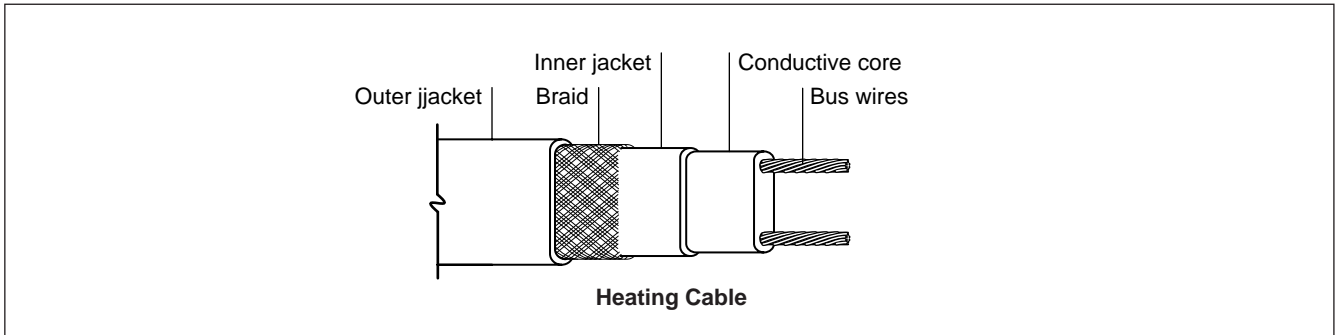

Power Connection Installation for XL-Trace -CR and -CT, and RaySol Heating Cables

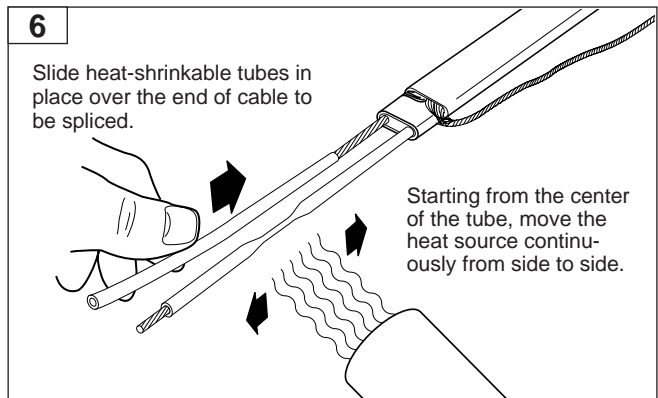
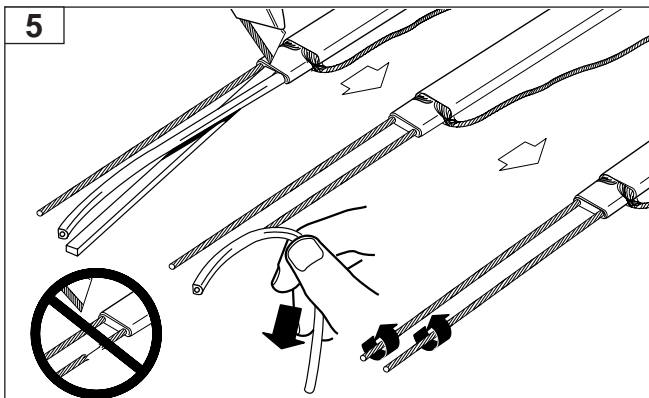
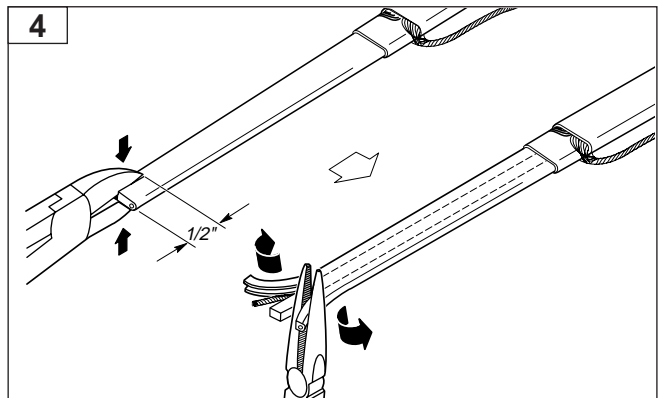
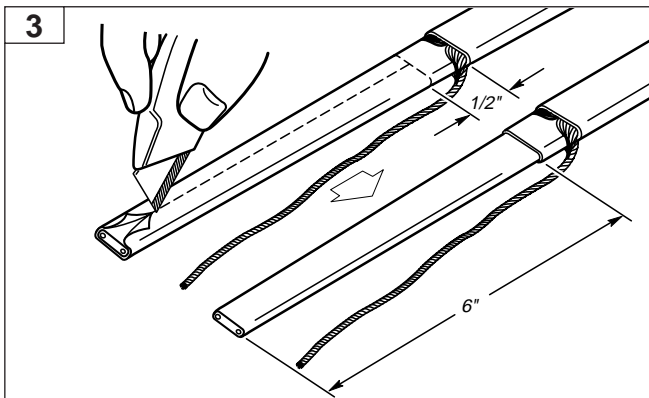
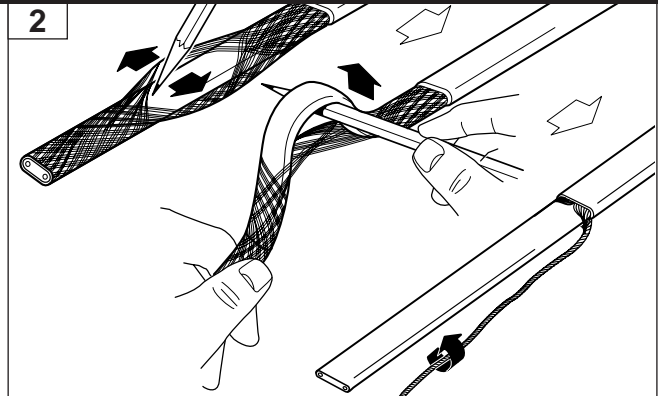
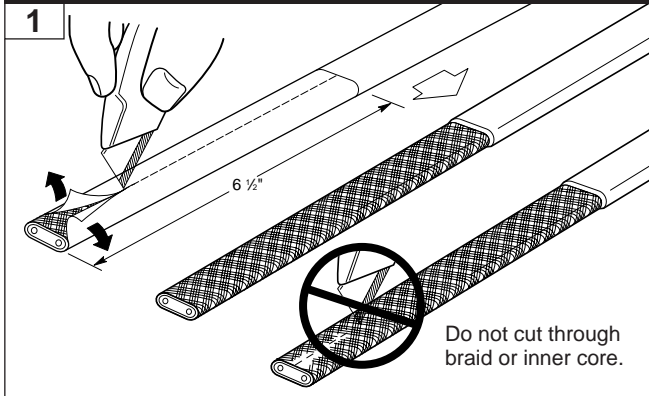

Installation Instructions

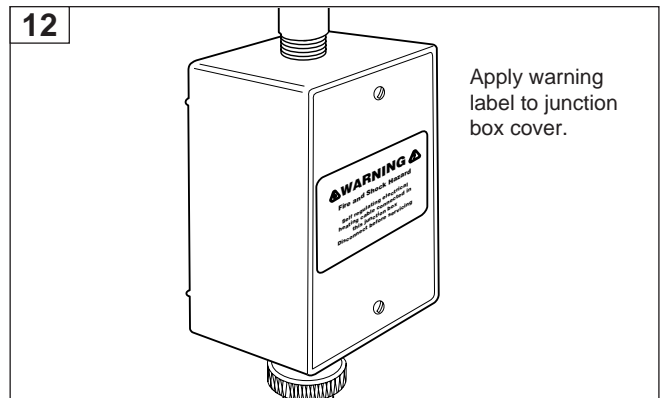
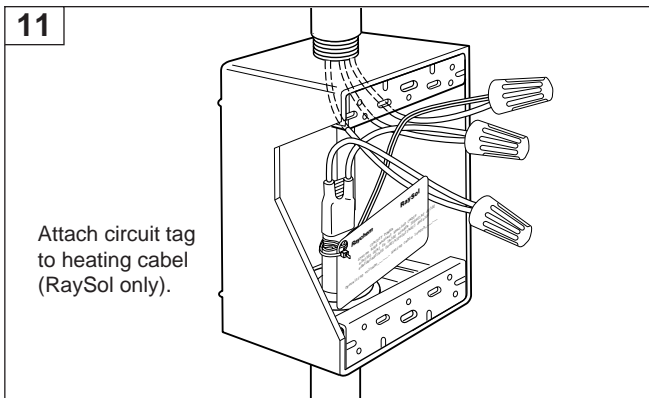
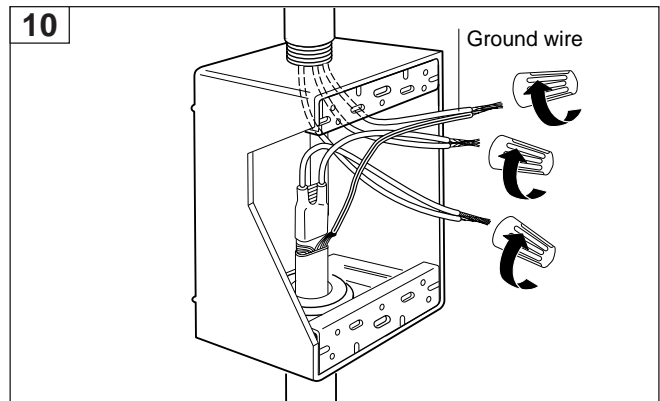
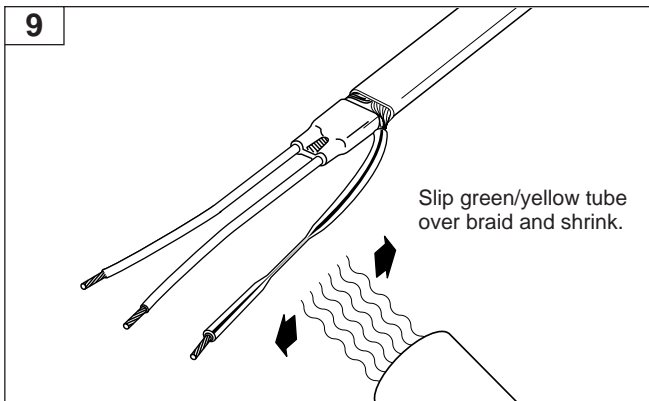
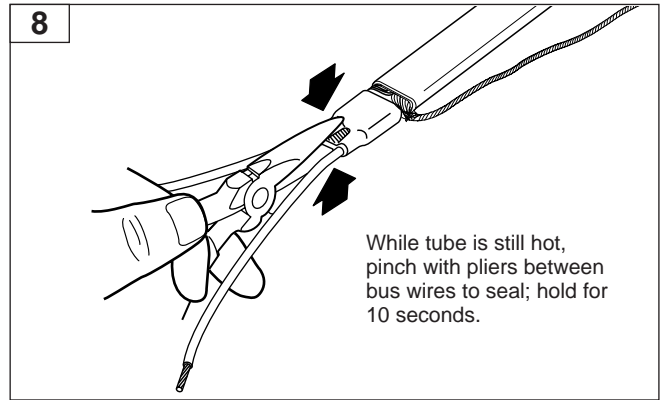
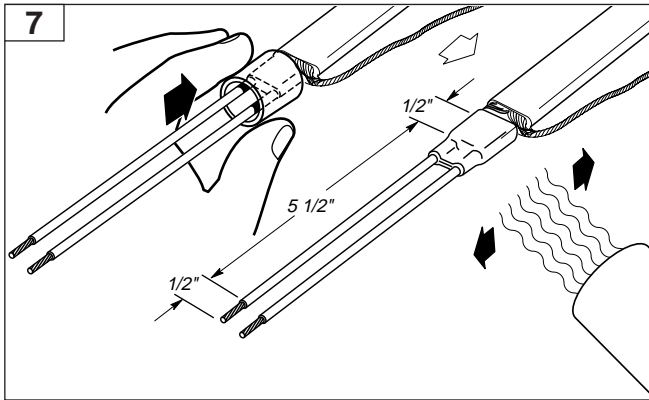

1
2
3
4
5
6
7
8
9
10

Installation Instructions

End Seal Installation for XL-Trace -CR and -CT, and RaySol Heating Cables

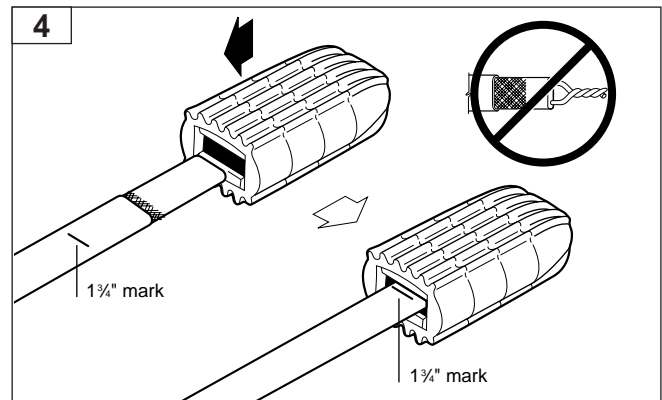
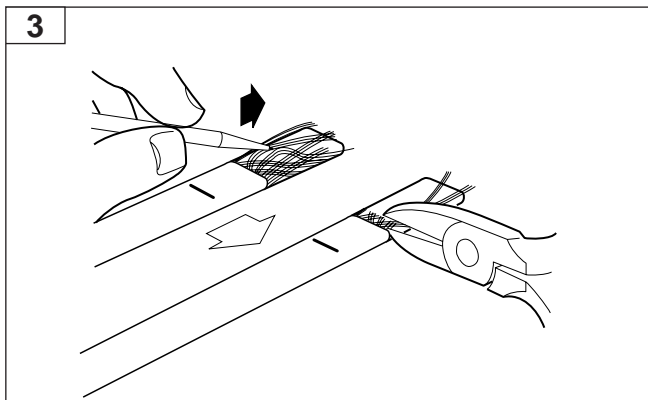
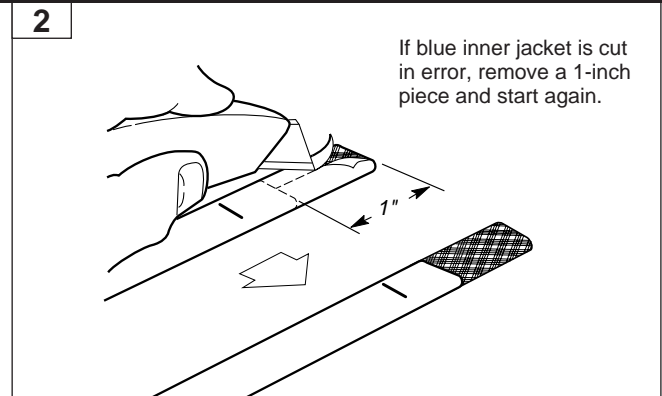
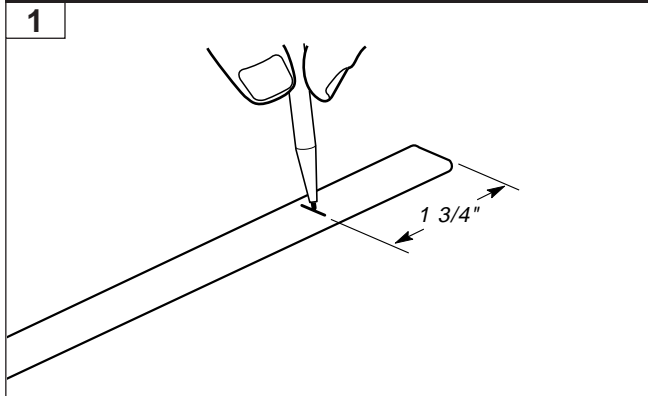

Raychem Corporation
Construction Products Group
300 Constitution Drive
Menlo Park, California 94025-1164
Tel (800) 542-8936
Fax (650) 361-5579

Raychem Canada Ltd.
3245 American Drive
Mississauga, Ontario
Canada L4V 1N4
Tel (800) 387-3993
Fax (905) 671-0972