

Installation Instructions

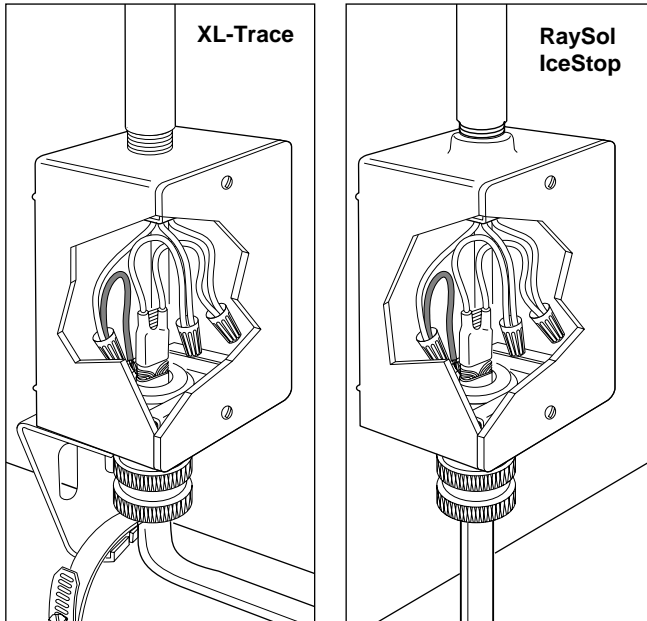

Description

The FTC-P Power Connection and End Seal Kit is for use with XL-Trace, RaySol, and IceStop heating cables. Materials for one power connection and one end seal are included in this kit. These installation instructions should be used in conjunction with either the XL-Trace, RaySol or IceStop System Installation and Operation Manual. For technical support call (800) 545-6258.

Tools Required

- Screw driver
- Pen
- Needle-nose pliers
- Diagonal cutters
- Utility knife
- Heat gun or propane torch

Additional Materials Required (not provided in this kit)

- UL Listed or CSA Certified junction box suitable for the location, with a clearance hole or threaded hub for 1/2-inch NPT. For RaySol applications, the power connection and end seal may be terminated in the same box.

Approvals



718K Pipe Heating Cable or 877Z De-Icing and Snow-Melting Equipment or 9J8 6 Radiant Heating Cable



DESIG. 3A, 3B, 3C, 1B, 2B, 2E



XL-Trace and IceStop GM-XT only Class I, Div. 2, Groups A, B, C, D hazardous locations with IceStop GM-1XT and GM-2XT only

Kit Contents

Item	Qty	Description
A	4	Warning labels
B	1	Pipe mounting bracket
C	1	Lock nut
D	1	Blue grommet
E	1	Sealing fitting
F	3	Wire nuts
G	1	Black heat-shrinkable tube (1/2" x 1 1/2")
H	1	Green/yellow heat-shrinkable tube (1/4" x 5 1/2")
I	2	Black heat-shrinkable tubes (1/8" x 5 1/2")
J	1	#3 pipe strap
K	1	Gel-filled end seal (FTC-E)
L	1	RaySol circuit tag
M	1	Sealing gasket

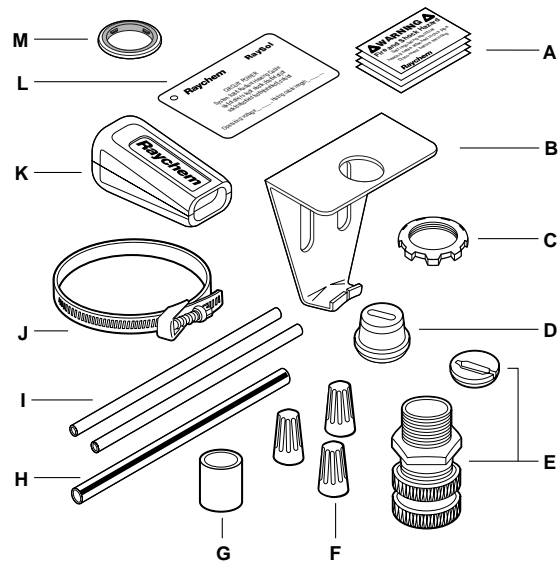

WARNING:

These components are electrical devices. They must be installed correctly to ensure proper operation and to prevent shock or fire. Carefully follow all of the installation instructions and read these important warnings.

- To minimize the danger of fire from sustained electrical arcing if the heating cable is damaged or improperly installed, and to comply with the requirements of Raychem and the 1996 National Electrical Code, ground-fault equipment protection must be used on each heating cable branch circuit. Arcing may not be stopped by conventional circuit breakers.
- Component approvals and performance are based on the use of specified parts only. Do not use substitute parts or vinyl electrical tape.
- The black heating-cable core is conductive and can short. It must be properly insulated and kept dry.

- Keep components and heating cable ends dry before and during installation.
- Damaged bus wires can overheat or short. Do not break bus wire strands when scoring the jacket or core.
- Bus wires will short if they contact each other. Keep bus wires separated.
- Heat-damaged components can short. Use a heat gun or a torch with a soft, yellow flame. Keep the flame moving to avoid overheating, blistering, or charring the heat-shrinkable tubes. Avoid heating other components. Replace any damaged parts.
- Use only fire-resistant insulation materials such as fiberglass wrap.
- Leave these installation instructions with the user for future reference.

CAUTION:

Charring or burning the heat-shrinkable tubes in this kit will produce fumes that may cause eye, skin, nose, and throat irritation. Consult Material Safety Data Sheet RAY/3122.

CHEMTREC 24-hour emergency telephone: (800) 424-9300.

Non-emergency health and safety information: (650) 361-4907.

FTC-P Power Connection and End Seal Kit Installation Instructions

Power Connection Installation

XL-Trace-CR and -CT,
RaySol, and IceStop

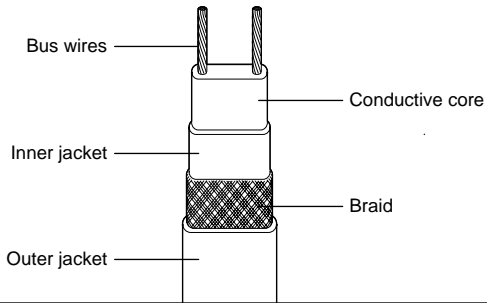

1

- Discard black grommet and use blue grommet.

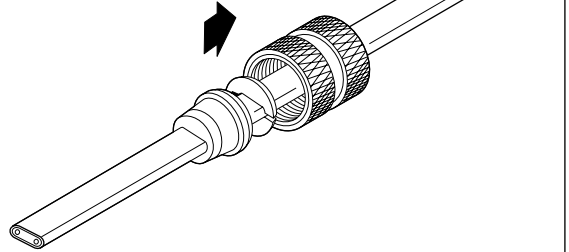

2

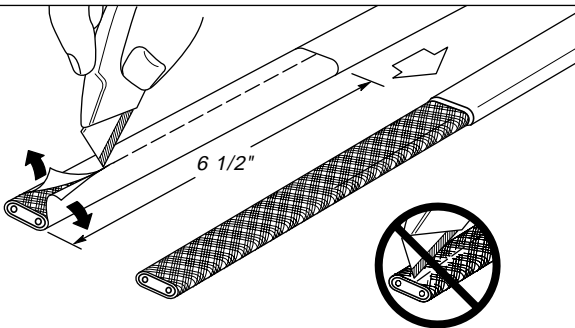

Do not cut through braid or inner core.

3

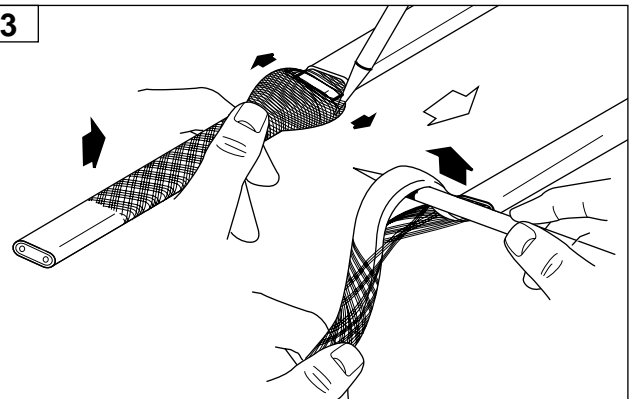

4

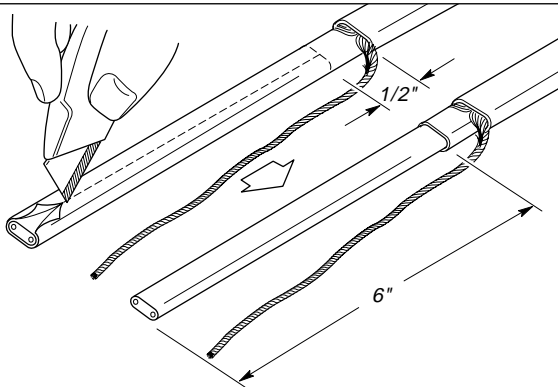

5

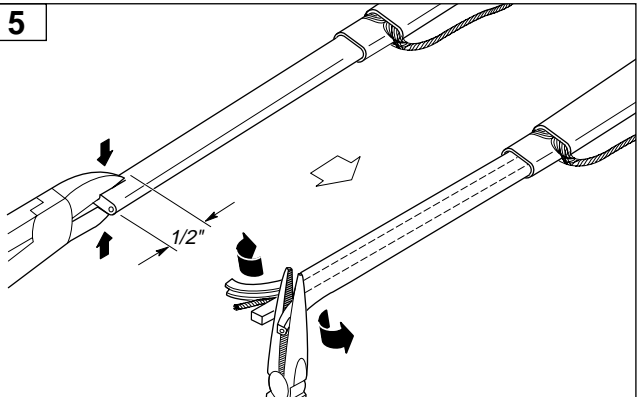

6

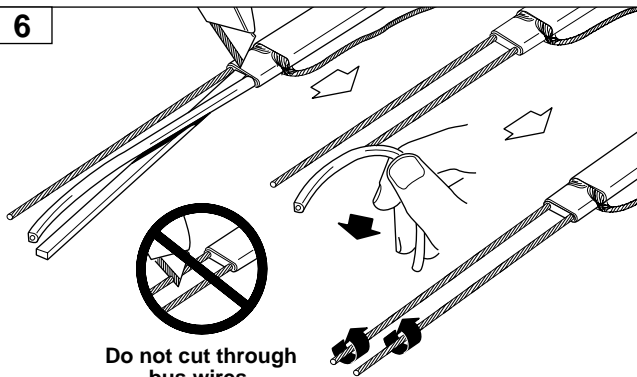

Do not cut through bus wires.

7

- Slide heat-shrinkable tubes over end of cable.

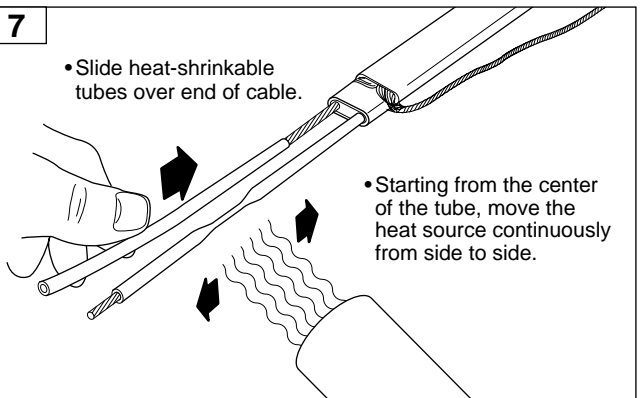

- Starting from the center of the tube, move the heat source continuously from side to side.

FTC-P Power Connection and End Seal Kit Installation Instructions

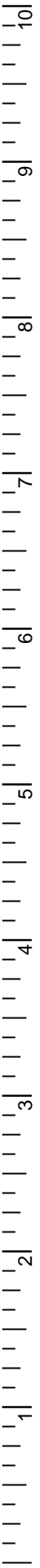
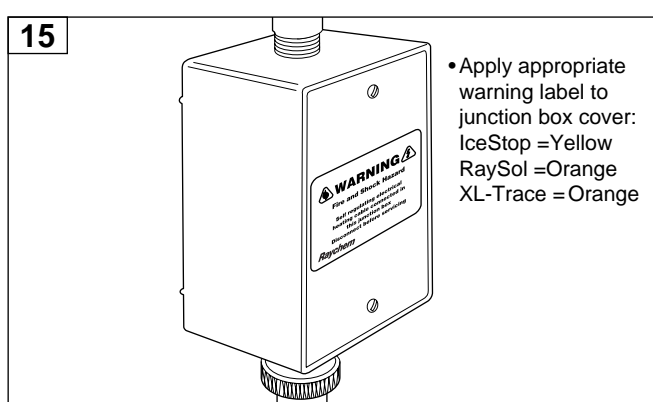
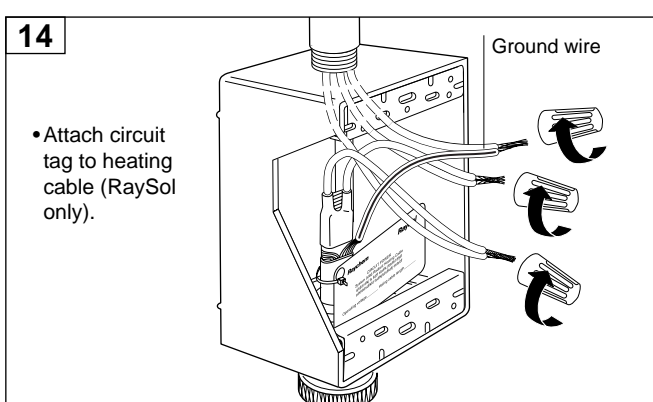
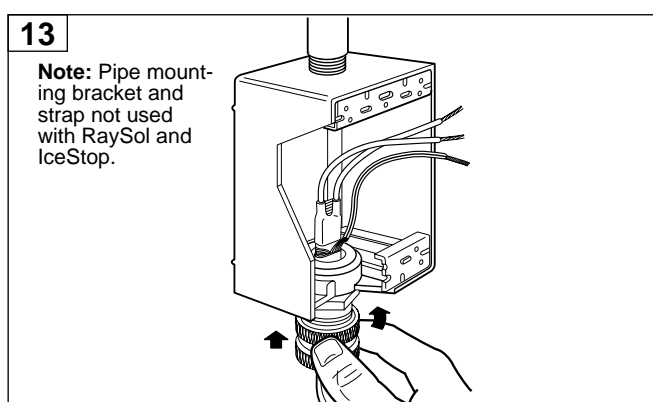
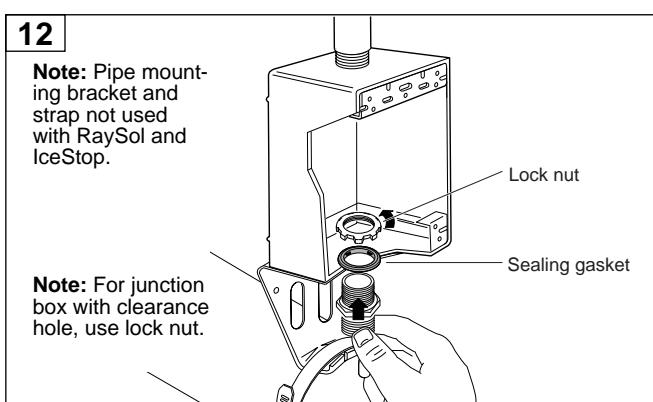
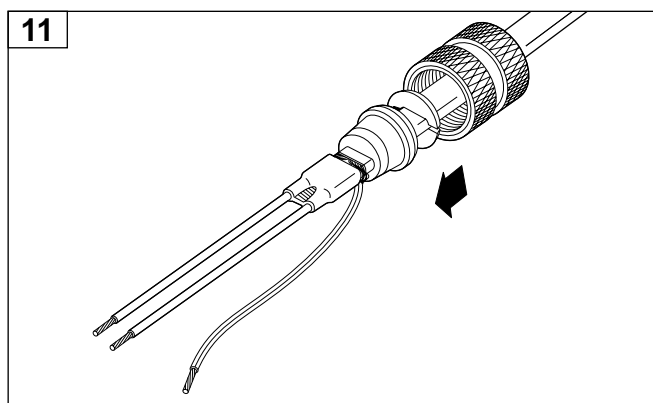
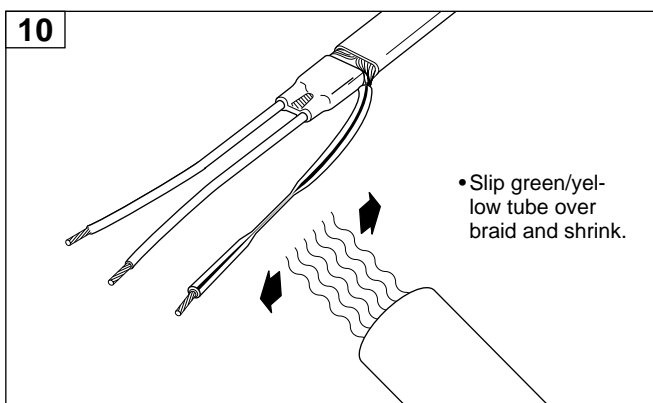
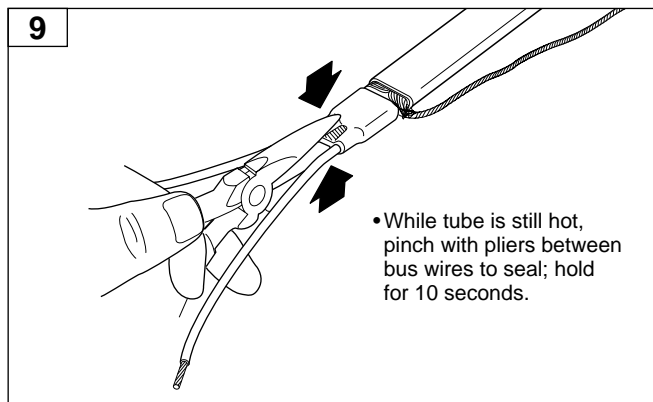
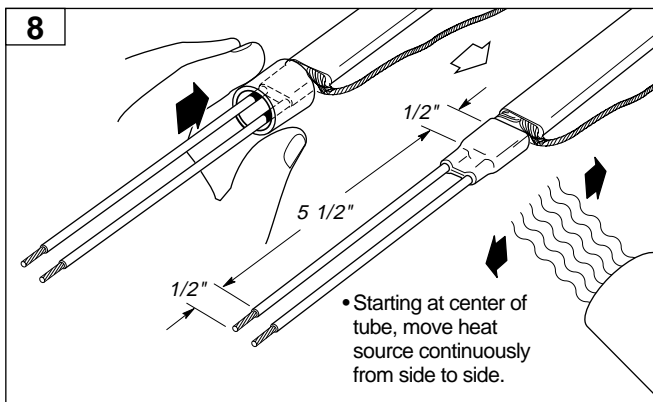

FTC-P Power Connection and End Seal Kit Installation Instructions

End Seal Installation for XL-Trace-CR and -CT, RaySol, and IceStop Heating Cables

1

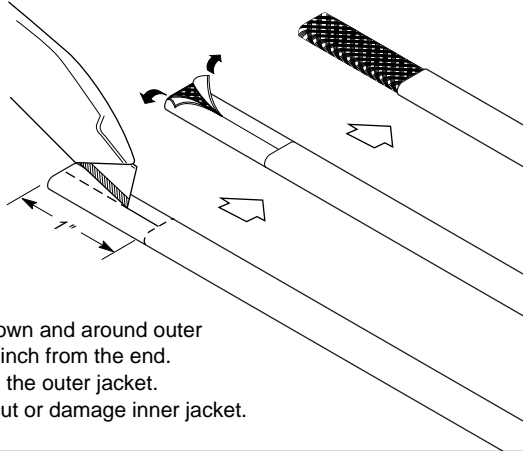

- Score down and around outer jacket 1 inch from the end.
- Remove the outer jacket.
- Do not cut or damage inner jacket.

2

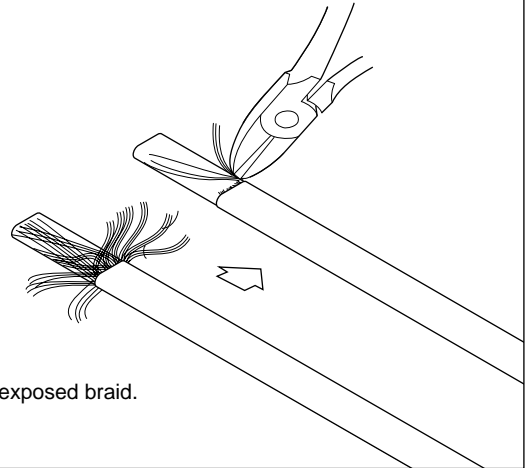

- Remove exposed braid.

3

- Push end seal completely onto heating cable.

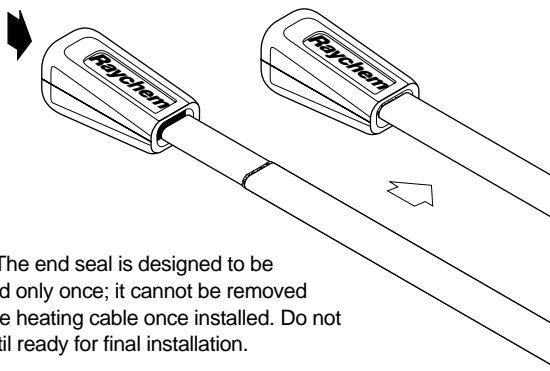

Note: The end seal is designed to be installed only once; it cannot be removed from the heating cable once installed. Do not use until ready for final installation.

IceStop, RaySol, and XL-Trace are trademarks of Raychem Corporation.

Raychem Corporation
 300 Constitution Drive
 Menlo Park, CA 94025-1164
 Tel (800) 545-6258
 Fax (800) 611-2323
 Fax-on-Demand (800) 329-4494
 ciinfo@raychem.com
 www.raychem.com

Raychem Canada Limited
 Toronto, Ontario
 Canada
 Tel (800) 988-5171
 Fax (800) 988-5172

Raychem S.A.I.C.
 Carlos Pellegrini 1163, Piso 7
 1009 Capital Federal
 Buenos Aires, Argentina
 Tel (54) 1/394-5150
 Fax (54) 1/326-9985